

DRIVE BELT INSPECTION [LF]

B3E011015800W05

Generator Drive Belt

Note

- Drive belt deflection/tension inspection is not necessary because of the use of the generator drive belt auto tensioner.

1. Verify that the drive belt auto tensioner indicator mark does not exceed the limit.

- If it exceeds the limit, replace the drive belt. (See [DRIVE BELT REPLACEMENT \[LF\]](#).)

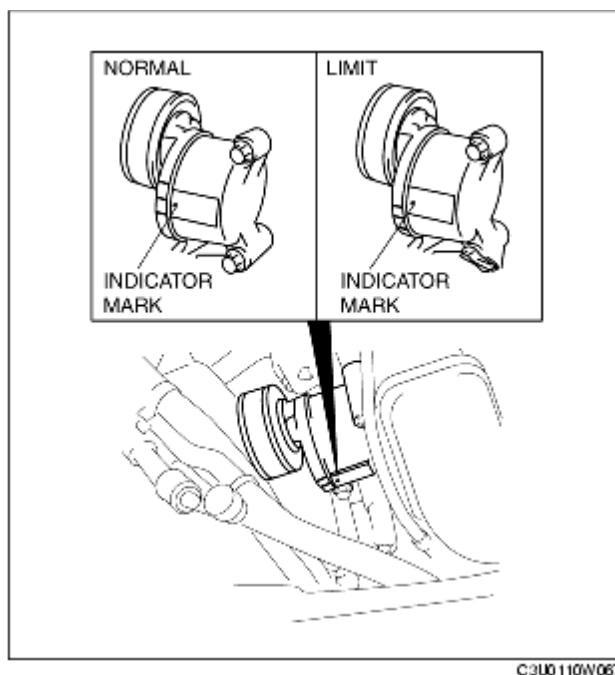

A/C Drive Belt

Note

- Drive belt deflection/tension inspection is not necessary because of the use of the maintenance-free type A/C drive belt.
- Replace the drive belt if it is found to be damaged during visual inspection, or if there is a malfunction or noise in the A/C compressor.